

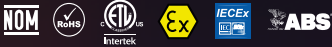

HAZARDOUS LOCATIONS H SERIES

Luminaire designed for hazardous applications. Its innovative vertical airflow cooling design allows it to operate in harsh, high-heat environments with temperatures up to 60°C, such as metal foundries, iron forges, steel mills, power generation facilities, factories, and chemical plants.

CERTIFICATIONS



Technical Data	
Input voltage	100 - 277V ~ / 200 - 480V ~
Input frequency	50 / 60 Hz
Dimmable	0 - 10 V (Optional)
Color temperature	4000K - 5000K
CRI	> 70
Operating temperature	-40 to 60° C
Harmonic distortion	<10 %
Power factor	0.90
Beam angle	120°
Mounting	U-mount bracket
Classification	IP66
Impact resistance	IK08
Anti-surge rating	10 kV
Light maintenance @100,000 hrs	0.86 *Projected L70 (I2K) = 72,000 hrs per IESTM-21
Body	Stainless steel
Optics	Polycarbonate
Color	Gray

Model	Nominal Power	Luminous Efficiency	Luminous Flux
2FT-20	20 W	140 lm/W	2,800 lumens
2FT-40	40 W	140 lm/W	5,600 lumens
4FT-40	40 W	140 lm/W	5,600 lumens
4FT-60	60 W	140 lm/W	8,400 lumens
4FT-80	80 W	140 lm/W	11,200 lumens



ATEX - European Union
I13 G Ex ec IIC T5/T6 Gc
II2 D Ex tb IIIC T80/100°C Db IP66



IECEX - International
Ex ec IIC T5/T6 Gc
Ex tb IIIC T80/100°C Db IP66



Intertek - North America
Class I, Division 2, Groups A, B, C, D
Class II, Division 1, Groups E, F, G
Class II, Division 2, Groups F, G
Class III



Intertek - North America
UL1598, UL1598A



ABS Type Approved

Otras Clasificaciones
IP66
IK10



Dimensions

2FT-20 / 2FT-40

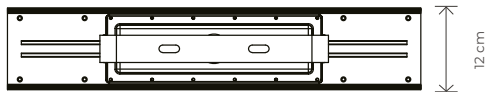
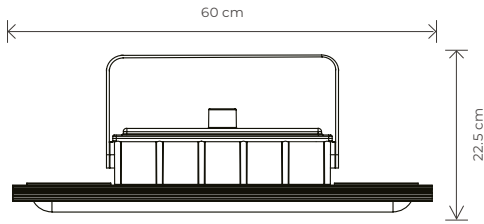

4FT-40 / 4FT-60

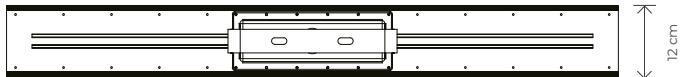
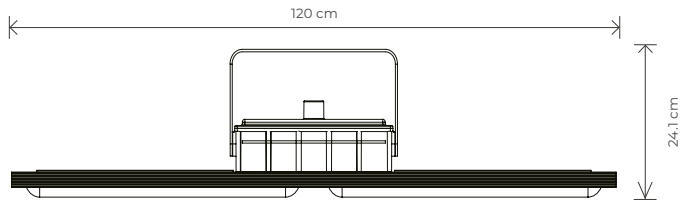

Photometric distribution

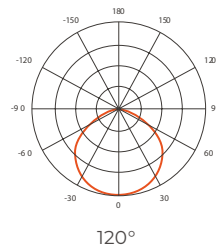

Hazardous Location Certified

U-Bracket Mounting

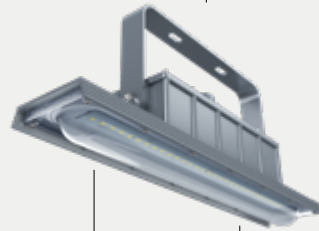

Lightweight design made of aerospace-grade aluminum

120° Beam Angle



Rated IK08 for impact Resistance



Sealed housing with IP66 Protection

Ordering Guide

1 Series	2 Model	3 Power supply
EXH	2FT20	2,800 lm
	2FT40	5,600 lm
	4FT40	5,600 lm
	4FT60	8,400 lm
	4FT80	11,200 lm
		S Standar
		D Dimmable

4 Color temperature	5 Voltage *
40 4000K	S 100 - 277 V~
50 5000K	H 200-480 V~

Code example:

1 Series	2 Model	3 Power supply	4 Color temperature	5 Voltage
EXH	2FT40	D	40	H

*High voltage not compatible with 2FT20